

McGILL®

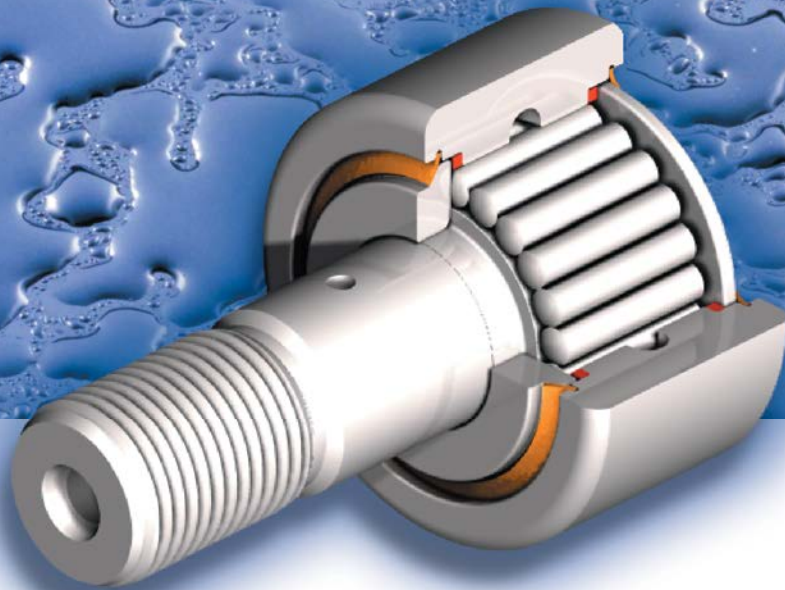

STAINLESS STEEL CAM FOLLOWERS

REGAL®

CRES™ CAMROL® Bearings

More Corrosion Resistance Compared to Standard and Competitive Designs:

440C construction helps withstand exposure to corrosive products and harsh sanitation chemicals.



Standard Cam Followers Rust Quickly

TEST	52100	440C
Acid Test Citric Acid, pH 2, 48 hr exposure		
Basic Test Chlorine bleach, 6% concentration, pH 12, 16 hr exposure		

Improve Sealing Compared to Standard and Competitive Designs:

LUBRI-DISC® + seal is provided in sizes 1" and larger and provides up to 5 times more protection compared to standard and competitive designs against washdown.. Regal originally developed this seal to meet the tough demands of aerospace applications.

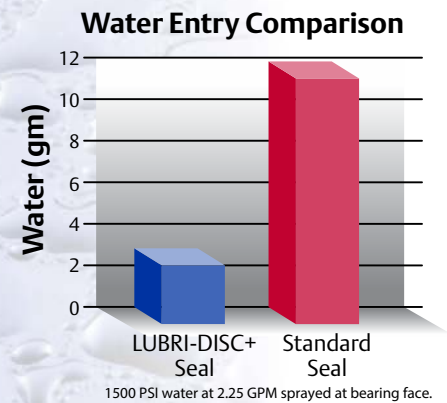
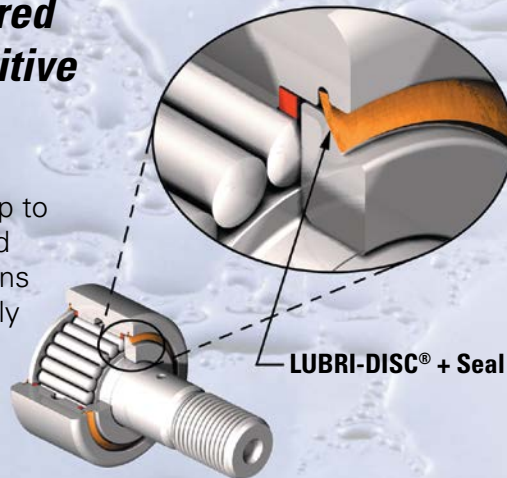

Quality Heat Treatment:

Zone hardening the raceway provides for high load ratings. The tough stem allows for the shocks of cam follower operation. Heat treatment is carefully controlled and every batch is inspected before the "McGILL®" name goes on the part.

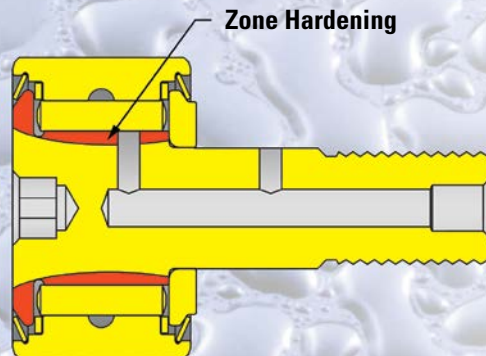

CRES™ CAMROL®

Stainless Steel Bearings



The Industry Leader...

The first ever needle bearing cam follower was a McGill® needle bearing cam follower. Since that time (1937), the McGill® CAMROL bearing line has maintained its leadership position through development of innovative solutions to the problems faced by industry.

The Problem Solver...CRES Cam Followers

McGill corrosion resistant CRES CAMROL cam followers are designed to help solve corrosion problems. Processors of food, beverage or pharmaceutical products face the ever present challenge of providing wholesome products. Many processors have adopted HACCP (Hazard Analysis and Critical Control Points) to ensure safe production. McGill CRES CAMROL bearings join the McGill brand family of CRES solutions to help meet your needs.



Components Material

- Bearing Races - 440C Stainless Steel
- Needles - 440C Stainless Steel
- Seal - LUBRI-DISC®+ Seal: Sizes 1" and larger
Standard LUBRI-DISC Seal: Sizes less than 1"

Features and Benefits

- 440C Stainless Steel - More corrosion resistant than common bearing steel
- Zone Hardened Raceway - Provides a hardened raceway for load capacity and stem ductility for absorbing shock loads
- LUBRI-DISC + Seal - Improved contamination resistance and lubrication retention
- H1 Food Grade Grease - Non-toxic grease with good corrosion resistance and wash out properties



Stud Series

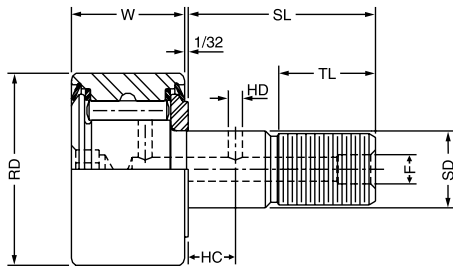

Yoke Series

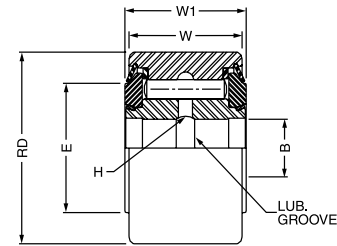

STANDARD STUD SERIES - Dimensions in Inches (*Dimensionally Interchangeable with Standard Cam Followers*)

Bearing Number	Roller Diameter RD +.000 -.001	Roller Width W +.000 -.005	Stud Diameter SD +.001 -.000	Stud Length SL	Min. Thread Length TL	Fine Threads Class 2A	Oil Hole		Lube Fitting Size F	Hex Hole Size H	Min. Boss Dia.	Rec'd Hsg. Bore +.0002 -.0003	Rec'd Torque* In.-Lbs.	Basic Dynamic Rating Lbs.
							Hole Center HC	Hole Dia. HD						
CF-1/2-SB-CR	.500	.375	.190	5/8	1/4	10-32	-	-	-	1/8	19/64	.1903	15	610
CF-9/16-SB-CR	.5625	.375	.190	5/8	1/4	10-32	-	-	-	1/8	19/64	.1903	15	610
CF-5/8-SB-CR	.625	.4375	.250	3/4	5/16	1/4-28	-	-	-	1/8	23/64	.2503	35	860
CF-11/16-SB-CR	.6875	.4375	.250	3/4	5/16	1/4-28	-	-	-	1/8	23/64	.2503	35	860
CF-3/4-SB-CR	.750	.500	.375	7/8	3/8	3/8-24	1/4	3/32	3/16	3/16	1/2	.3753	95	1490
CF-7/8-SB-CR	.875	.500	.375	7/8	3/8	3/8-24	1/4	3/32	3/16	3/16	1/2	.3753	95	1490
CF-1-SB-CR	1.000	.625	.4375	1	1/2	7/16-20	1/4	3/32	3/16	1/4	41/64	.4378	250	2000
CF-1 1/8-SB-CR	1.125	.625	.4375	1	1/2	7/16-20	1/4	3/32	3/16	1/4	41/64	.4378	250	2000
CF-1 1/4-SB-CR	1.250	.750	.500	1 1/4	5/8	1/2-20	5/16	3/32	3/16	1/4	49/64	.5003	350	3530
CF-1 3/8-SB-CR	1.375	.750	.500	1 1/4	5/8	1/2-20	5/16	3/32	3/16	1/4	49/64	.5003	350	3530
CF-1 1/2-SB-CR	1.500	.875	.625	1 1/2	3/4	5/8-18	3/8	3/32	3/16	5/16	57/34	.6253	650	4350
CF-1 5/8-SB-CR	1.625	.875	.625	1 1/2	3/4	5/8-18	3/8	3/32	3/16	5/16	57/34	.6253	650	4350
CF-1 3/4-SB-CR	1.750	1.000	.750	1 3/4	7/8	3/4-16	7/16	3/32	3/16	5/16	1 3/64	.7503	1250	5730
CF-1 7/8-SB-CR	1.875	1.000	.750	1 3/4	7/8	3/4-16	7/16	3/32	3/16	5/16	1 3/64	.7503	1250	5730
CF-2-SB-CR	2.000	1.250	.875	2	1	7/8-14	1/2	1/8	3/16	7/16	1 13/64	.8753	1500	7270

*Clamping torque is based on dry threads. Use 1/2 of value if threads are lubricated.

YOKE SERIES - Dimensions in Inches (*Dimensionally Interchangeable with Standard Cam Followers*)

Bearing Number	Roller Diameter RD +.000 -.001	Roller Width W +.000 -.005	Bore B +.0002 -.0004	Width Across Endplates WI +.0050 -.0100	Dia. of Endplates E	Oil Hole H	Min. Boss Dia.	Recommended Shaft Dia.			Basic Dynamic Rating Lbs.
								Push Fit +/- .0002	Drive Fit +/- .0002	Press Fit +/- .0002	
CYR-3/4-S-CR	.750	.500	.2500	.5625	39/64	3/32	1/2	.2495	.2501	.2503	1490
CYR-7/8-S-CR	.875	.500	.2500	.5625	39/64	3/32	1/2	.2495	.2501	.2503	1490
CYR-1-S-CR	1.000	.625	.3215	.6875	11/16	3/32	41/64	.3120	.3126	.3128	2000
CYR-1 1/8-S-CR	1.125	.625	.3215	.6875	11/16	3/32	41/64	.3120	.3126	.3128	2000
CYR-1 1/4-S-CR	1.250	.750	.3750	.8125	7/8	3/32	49/64	.3745	.3751	.3753	3530
CYR-1 3/8-S-CR	1.375	.750	.3750	.8125	7/8	3/32	49/64	.3745	.3751	.3753	3530
CYR-1 1/2-S-CR	1.500	.875	.4375	.9375	63/64	3/32	57/64	.4370	.4376	.4378	4350
CYR-1 5/8-S-CR	1.625	.875	.4375	.9375	63/64	3/32	57/64	.4370	.4376	.4378	4350
CYR-1 3/4-S-CR	1.750	1.000	.500	1.0625	1 7/64	3/32	1 3/64	.4995	.5001	.5005	5730
CYR-1 7/8-S-CR	1.875	1.000	.500	1.0625	1 7/64	3/32	1 3/64	.4995	.5001	.5005	5730
CYR-2-S-CR	2.000	1.250	.625	1.3125	1 19/64	3/32	1 13/64	.6245	.6251	.6255	7270



Problem:

"Cleanliness is a priority in my plant. Our HACCP plans call for no rust on our equipment and we must have food grade grease in our bearings. We regularly wash down our equipment, but some bearings are not stainless steel and can rust quickly."

"I can't afford downtime due to bearing failure. Our high speed lines require reliability to meet tight shipping schedules. Any unplanned maintenance creates hassles, especially in our busy season."

"I don't have the resources to redesign this equipment with a different component that may not fit or doesn't have comparable ratings."

Solution:

- Components manufactured from 440C stainless steel.
- H1 food grade grease.

- LUBRI-DISC® seals help keep lubricant inside and contaminants out.
- LUBRI-DISC + seals offer improved contamination protection against liquid on 1" and larger sizes.
- Zone hardening of stud provides a hardened raceway and a tough stem that give ductility and strength for absorbing the shocks of cam follower operation.

- Freedom to improve your operation with full dimensional interchange to standard cam followers and high load ratings.
- Nomenclature is unchanged except for "CR" designation (example: CF-1-SB becomes CF-1-SB CR).
- Popular size availability 1/2 to 2" (stud style); 3/4 to 2" (yoke style).

CRESTM CAMROL® Cam Follower Uses:



Beverage

- Soft Drinks
- Beer
- Bottled Water
- Juices
- Fluid Dairy Products

Applications

- Fillers
- Cappers
- Seamers
- Unscramblers
- Labelers

Food

- Eggs
- Fruits
- Poultry
- Prepared Foods
- Seafood
- Vegetables



Applications

- Case Packers
- Cartoners
- Grinders
- Juicers
- Palletizers
- Sorters



Pharmaceuticals

- Capsules
- Pills
- Solutions

Applications

- Compactors
- Fillers
- Sealers



McGILL®

Regal Beloit America, Inc.

7120 New Buffington Road

Florence, KY 41042

Customer Service: 800-626-2120

Fax: 800-262-3292

Technical Service: 800-626-2093

www.regalbeloit.com

APPLICATION CONSIDERATIONS

The proper selection and application of power transmission products and components, including the related area of product safety, is the responsibility of the customer. Operating and performance requirements and potential associated issues will vary appreciably depending upon the use and application of such products and components. The scope of the technical and application information included in this publication is necessarily limited. Unusual operating environments and conditions, lubrication requirements, loading supports, and other factors can materially affect the application and operating results of the products and components and the customer should carefully review its requirements. Any technical advice or review furnished by Regal Beloit America, Inc. and/or its affiliates ("Regal") with respect to the use of products and components is given in good faith and without charge, and Regal assumes no obligation or liability for the advice given, or results obtained, all such advice and review being given and accepted at customer's risk.

For a copy of our Standard Terms and Conditions of Sale, please visit <http://www.regalbeloit.com> (please see link at bottom of page to "Standard Terms and Conditions of Sale"). These terms and conditions of sale, disclaimers and limitations of liability apply to any person who may buy, acquire or use a Regal product referred to herein, including any person who buys from a licensed distributor of these branded products.

Regal, CAMROL, CRES, LUBRI-DISC and McGill are trademarks of Regal Beloit Corporation or one of its affiliated companies.
©2015, 2018 Regal Beloit Corporation, All Rights Reserved. MCB18020E • Form# 9930E

REGAL®